

6 AMC



Spring mount is necessary in all machinery, which, by virtue of its design, has reciprocating or rotating parts, creates vibration to some degree through the imbalance of the moving parts.

This vibration produced by a machine leads to different problems, such as a reduction in the machine's useful life through part wear, plus the transmission of this vibration to other non-insulated adjacent structures, giving rise to problems of noise and vibration transmission. It is therefore important to install a spring mount to machinery.



DRAWINGS

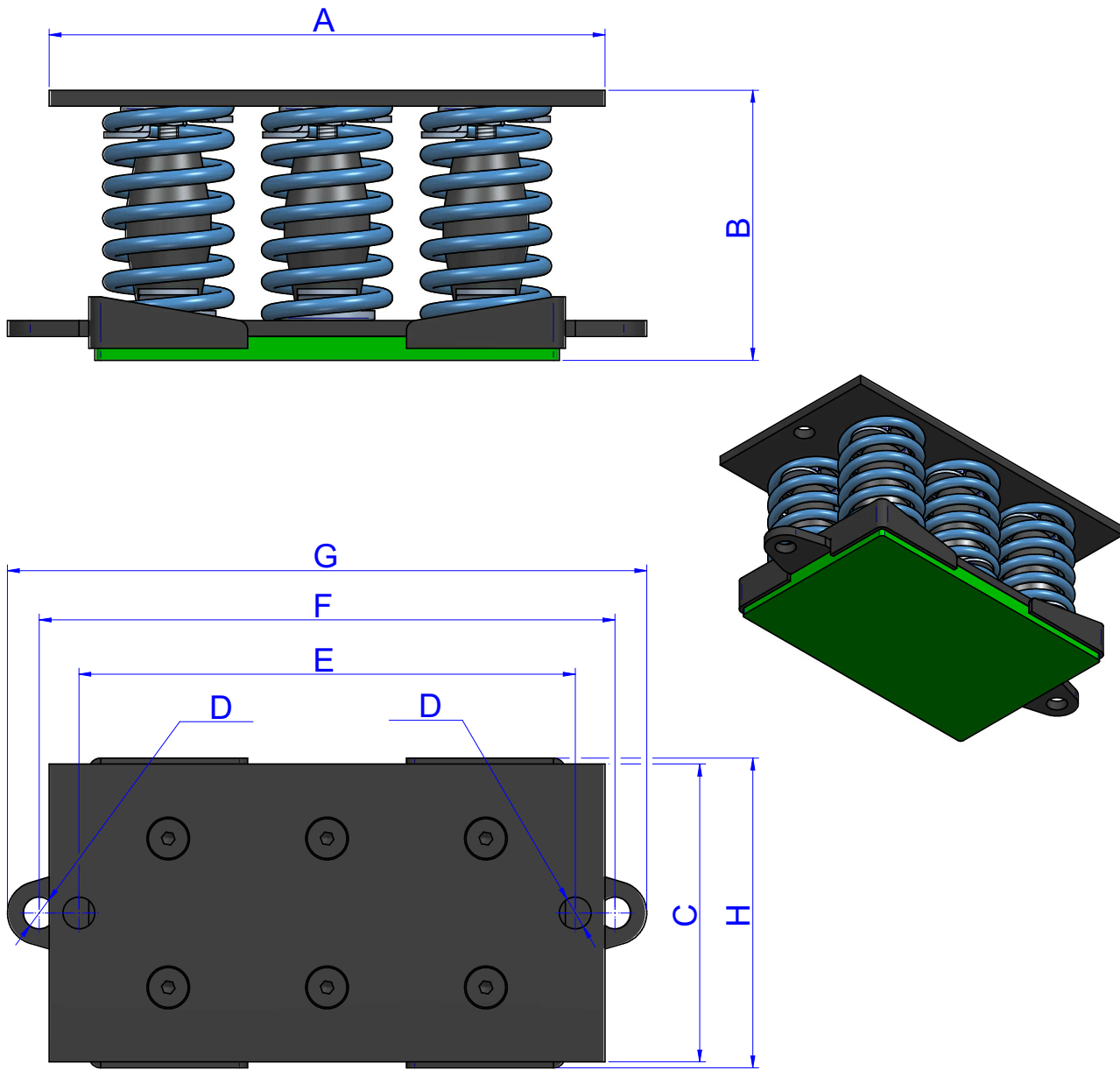

DIMENSIONS

Type	Spring color	A (mm)	B (mm)	C (mm)	D (mm)	E (mm)	F (mm)	G (mm)	H (mm)	Max. Load (kg)	Weight (kg)	Code
6 AMC 900+Sylomer®	BLUE	280	136	150	16	250	290	322	156	900	8,928	20871
6 AMC 1200+Sylomer®	WHITE	280	136	150	16	250	290	322	156	1200	9,156	20872
6 AMC 1500+Sylomer®	BLACK	280	136	150	16	250	290	322	156	1500	9,684	20873
6 AMC 2100+Sylomer®	CREAM	280	136	150	16	250	290	322	156	2100	10,77	20874
6 AMC 3000+Sylomer®	LIGHT GREY	350	136	200	18	300	360	396	206	3000	16,848	20875
6 AMC 4500+Sylomer®	GREEN	350	136	200	18	300	360	396	206	4500	19,656	20876

DRAWINGS

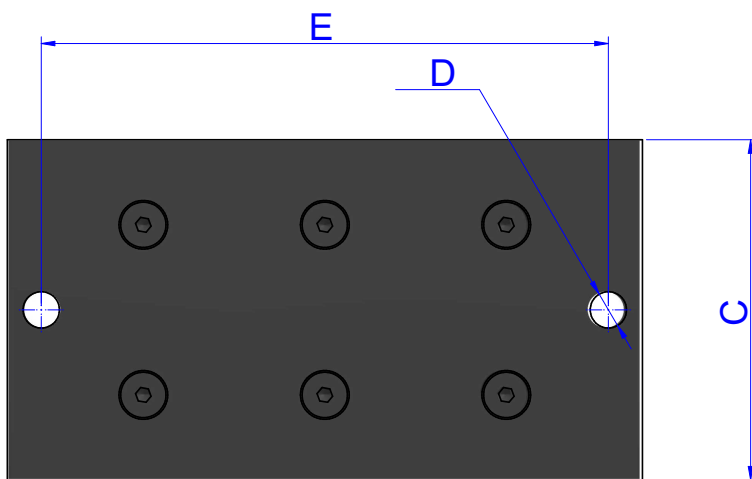
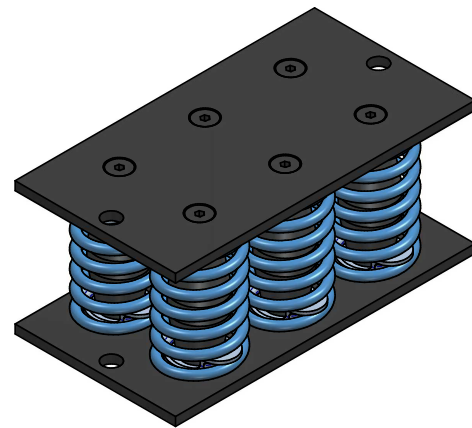
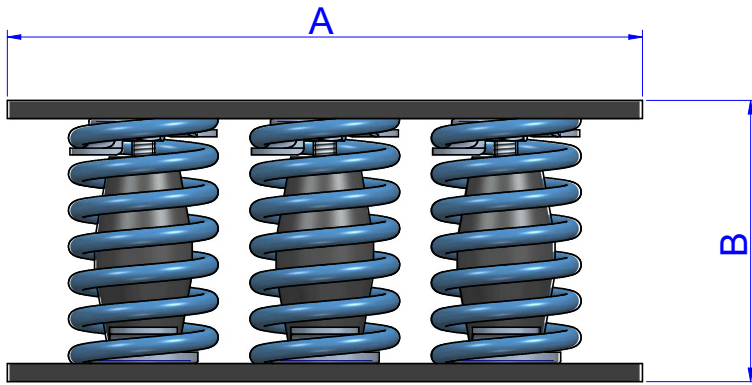

DIMENSIONS

Type	Spring color	A (mm)	B (mm)	C (mm)	D (mm)	E (mm)	F (mm)	G (mm)	H (mm)	Max. Load (kg)	Weight (kg)	Code
6 AMC 900	BLUE	280	124	150	16	250	-	-	-	900	8,928	20801
6 AMC 1.200	WHITE	280	124	150	16	250	-	-	-	1200	9,156	20811
6 AMC 1.500	BLACK	280	124	150	16	250	-	-	-	1500	9,684	20821
6 AMC 2.100	CREAM	280	124	150	16	250	-	-	-	2100	10,77	20831
6 AMC 3.000	LIGHT GREY	350	124	200	18	300	-	-	-	3000	16,848	20841
6 AMC 4.500	GREEN	350	124	200	18	300	-	-	-	4500	19,656	20851

Elastical properties

**LOAD DEFLECTION GRAPH
AMC MECANOCAUCHO® 6 AMC**

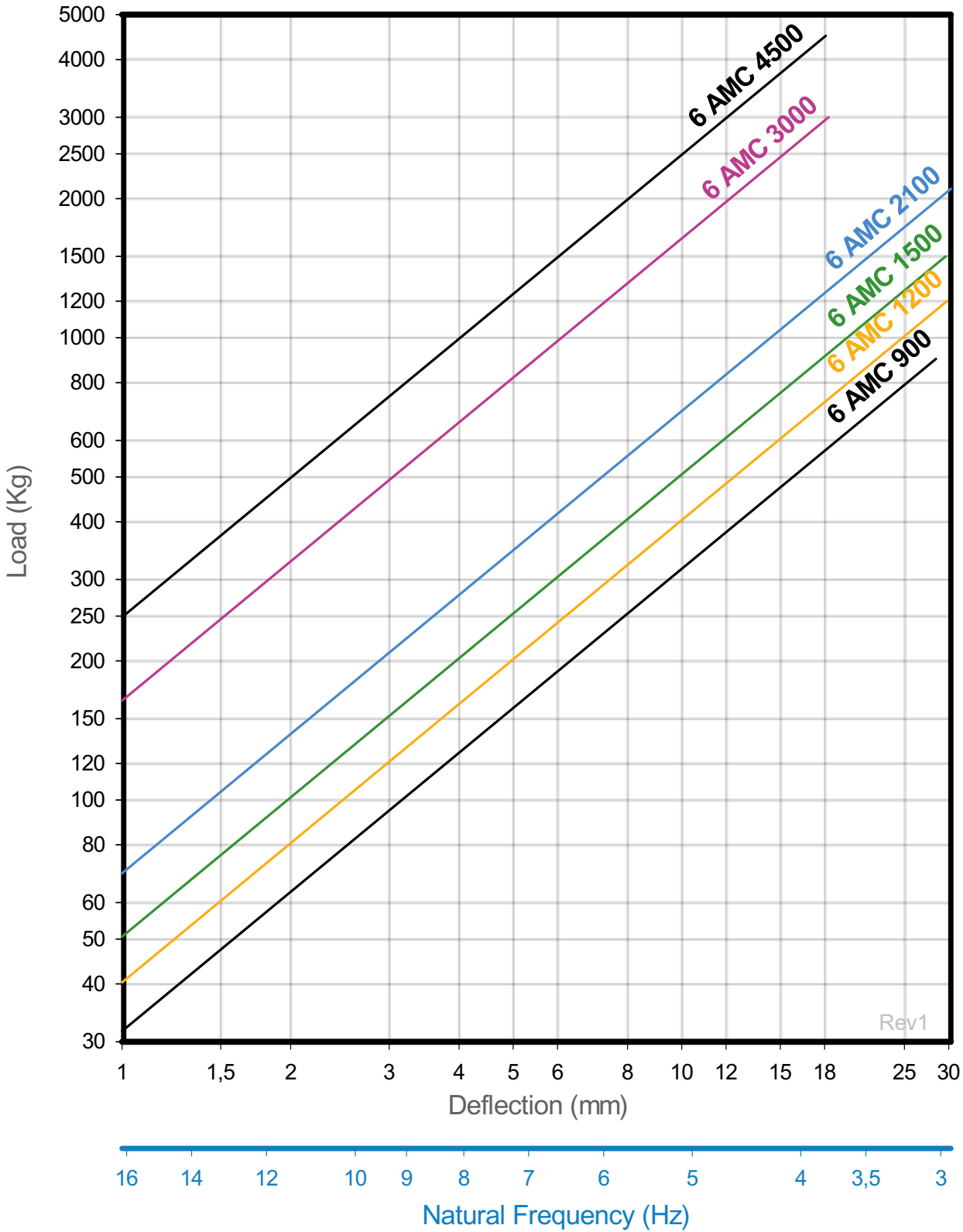

Rev1